

VANDA FULL FLUSHBOX AND FLUSH FIT TRACK
Sample Installation Detail



Product Code Ref :

(Flush Fit)
(Flushbox)

Ceiling Structure

Exterior wall cladding

Insulation

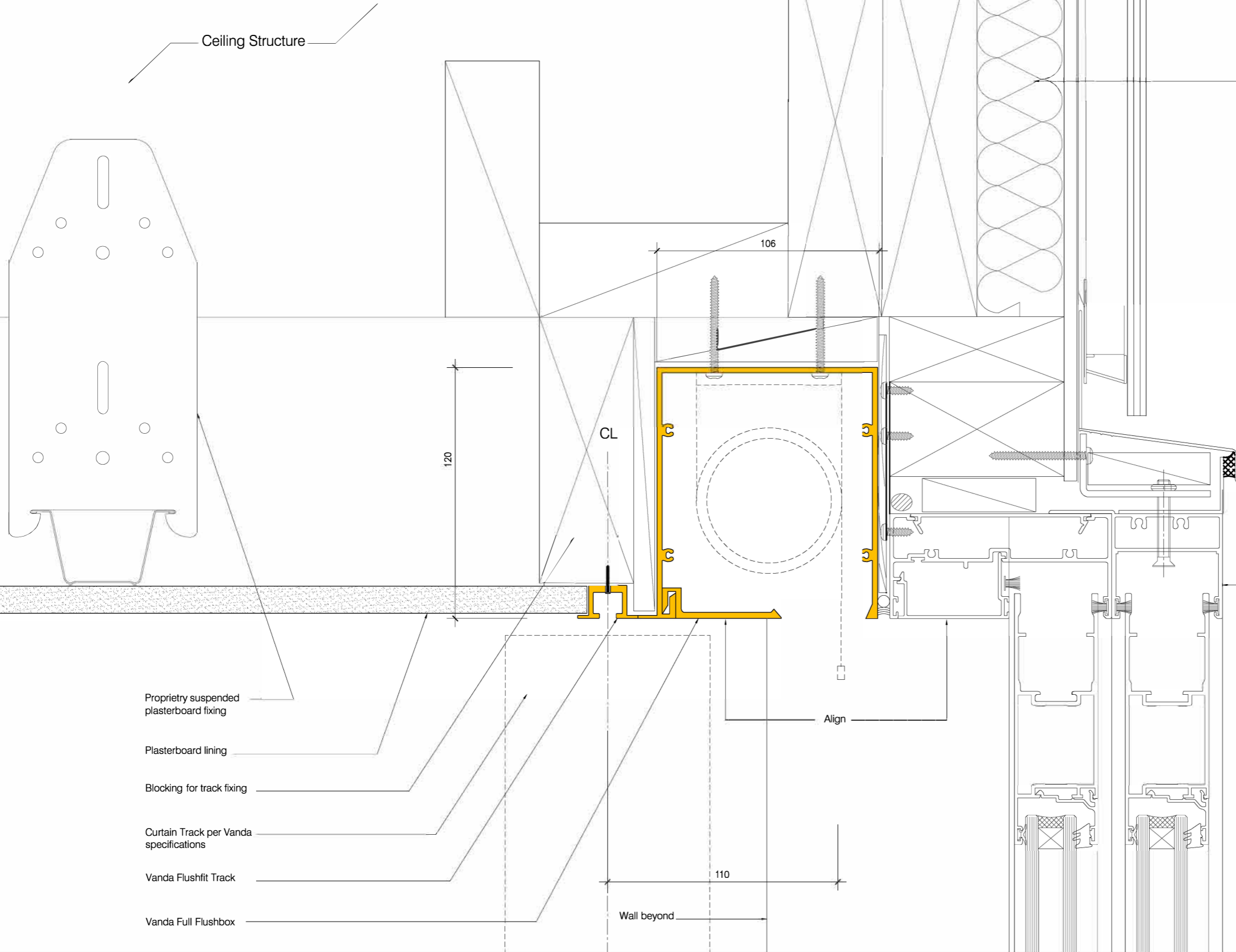

Proprietary suspended plasterboard fixing

Plasterboard lining

Blocking for track fixing

Curtain Track per Vanda specifications

Vanda Flushfit Track

Vanda Full Flushbox

Align

Aluminium joinery
(to allow for flush fit between door/window head and bottom of flush box coordinate extrusion with joinery manufacturer)

PRODUCT :

Vanda Full Flushbox and Flush Fit Track

DESCRIPTION :

Single Recessed aluminium box and cover plate designed to be recessed into ceiling to conceal blind. Blind runs close to window. The Flushfit aluminium track is designed flush to the ceiling with a minimal flange.

MATERIAL :

Powder coated aluminium in standard Vanda White or any Dulux powdercoat colour.

NOTES :

Ensure there is space for window/door handles.

Flushfit Track flange butts up next to Flushbox Flange. Contractors to pack out space between track and box 13mm to help locate both sections.

DISCLAIMER :

Note that the architectural detail is shown for reference only. All architectural details shown shall not be used for construction, and shall be drawn by an architect according to the specific building project and application. Drawing intent shows the possible placement of Vanda products within a building context.

1:2 Scale (A3)

